

P1045 3 HOLE Z-SHAPED CHANNEL BRACKET

T231-310



DESCRIPTION

41mm Z Bracket

FINISH

Hot Dipped Galvanised

MATERIAL

Steel

PACKAGING

Packed in boxes of 25

ADDITIONAL NOTES

Compliant to LU Standard 1-085
(for use on surface & sub-surface locations)

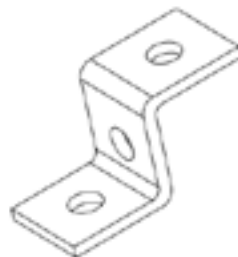

Isometric view

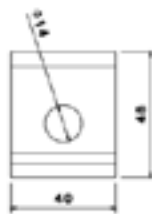

Front view

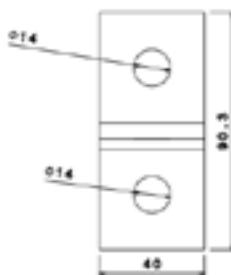

Top view

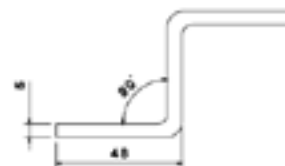

side view